

# INVOICE

**FROM:**

Advanced Appraisal Services  
 Advanced Appraisal Services  
 PO Box 11373  
 Knoxville, TN 37939-1373

Telephone Number: (865) 588-4008      Fax Number: (865) 637-2394

**TO:**

The Holli McCray Group

Knoxville, TN

E-Mail: verdeaux@kw.com

Telephone Number: (865) 851-0181      Fax Number:

Alternate Number:

INVOICE NUMBER	
0045076	
DATES	
Invoice Date:	07/15/2019
Due Date:	07/15/2019
REFERENCE	
Internal Order #:	0045076
Lender Case #:	
Client File #:	
FHA/VA Case #:	
Main File # on form:	0045076
Other File # on form:	0045076
Federal Tax ID:	62-1867763
Employer ID:	

**DESCRIPTION**

<b>Lender:</b> The Holli McCray Group	<b>Client:</b> The Holli McCray Group
<b>Purchaser/Borrower:</b> The Holli McCray Group	
<b>Property Address:</b> 324 Triple Crown	
<b>City:</b> Knoxville	
<b>County:</b> Knox	<b>State:</b> TN <b>Zip:</b> 37932
<b>Legal Description:</b> Lot 28 Steeplechase	

**FEES**

**AMOUNT**

Measurement	75.00
Interior	0.00
<b>SUBTOTAL</b>	
	75.00

**PAYMENTS**

**AMOUNT**

<b>Check #:</b>	<b>Date:</b>	<b>Description:</b>	
Check #:	Date:	Description:	
Check #:	Date:	Description:	
<b>SUBTOTAL</b>			0
<b>TOTAL DUE</b>			<b>\$ 75.00</b>

**Supplemental Addendum**

File No. 0045076

Borrower	The Holli McCray Group		
Property Address	324 Triple Crown		
City	Knoxville	County	Knox
		State	TN
		Zip Code	37932
Lender/Client	The Holli McCray Group		

**324 Triple Crown- 2785 sq ft**

**1st Level- 1830 sq ft**

- Living 12 x 16
- Kitchen 11 x 9
- Dining 20 x 11
- Bed 2 12 x 11
- Sitting 11 x 9
- Bath 8 x 7
- Master Bed 19 x 12
- Master Bath 14 x 10
- Laundry 10 x 6

**2nd Level- 955 sq f**

- Bonus 22 x 12
- Loft 20 x 18
- Bed 20 x 13

Signature \_\_\_\_\_  
 Name Jeremy Skalet  
 Date Signed \_\_\_\_\_  
 State Certification # 3215 State TN  
 Or State License # \_\_\_\_\_ State \_\_\_\_\_

Signature \_\_\_\_\_  
 Name \_\_\_\_\_  
 Date Signed \_\_\_\_\_  
 State Certification # \_\_\_\_\_ State \_\_\_\_\_  
 Or State License # \_\_\_\_\_ State \_\_\_\_\_

## Subject Photo Page

Borrower	The Holli McCray Group				
Property Address	324 Triple Crown				
City	Knoxville	County	Knox	State	TN
Lender/Client	The Holli McCray Group				
				Zip Code	37932



### Subject Front

- 324 Triple Crown
- Sales Price
- Gross Living Area
- Total Rooms
- Total Bedrooms
- Total Bathrooms
- Location
- View
- Site
- Quality
- Age



### Subject Rear

### Subject Street

### Building Sketch

Borrower	The Holli McCray Group				
Property Address	324 Triple Crown				
City	Knoxville	County	Knox	State	TN
Zip Code	37932				
Lender/Client	The Holli McCray Group				

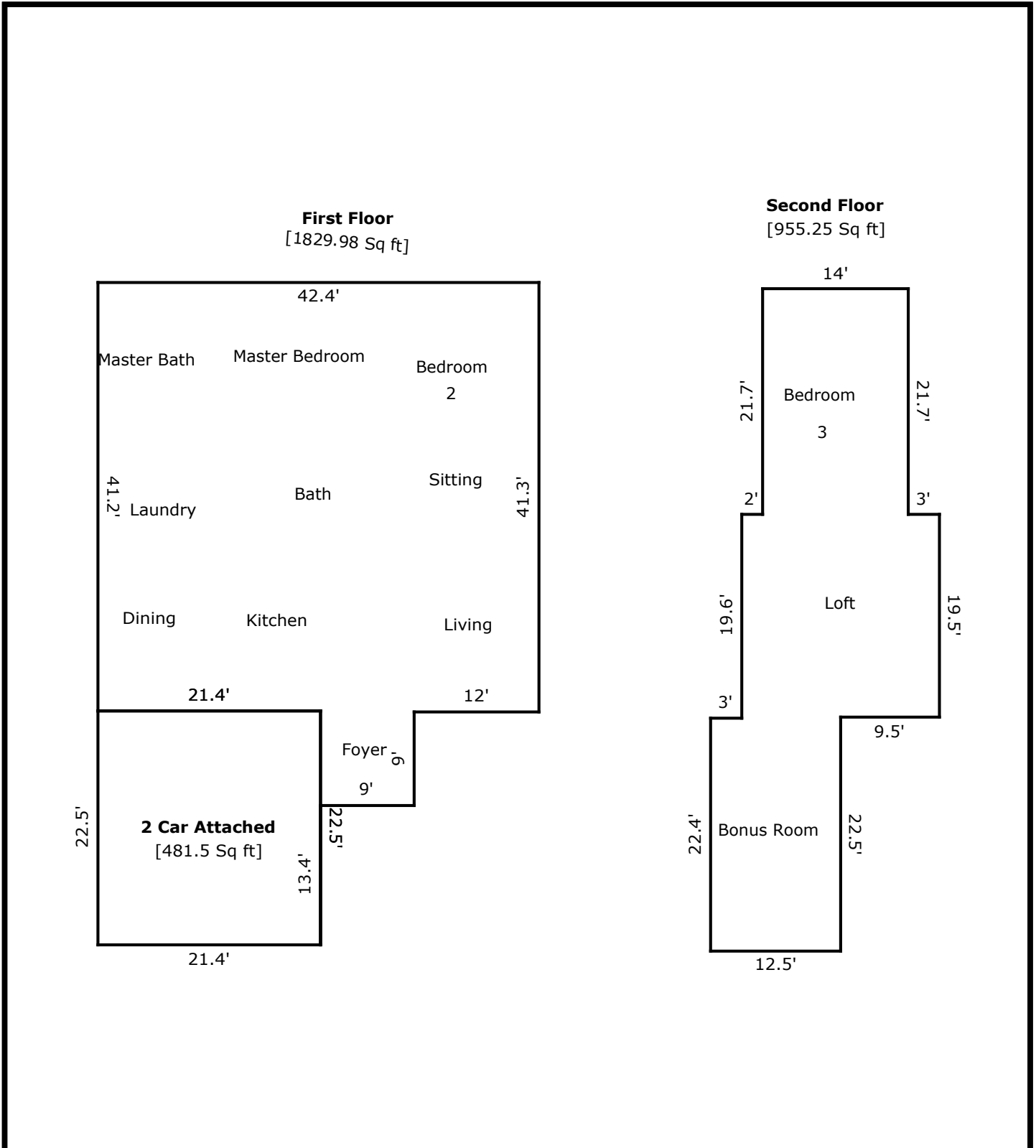

TOTAL Sketch by a la mode, inc.

#### Area Calculations Summary

Living Area		Calculation Details	
First Floor	1829.98 Sq ft	9 × 9 =	81
		42.4 × 41.2 =	1746.88
		0.1 × 21 =	2.1
Second Floor	955.25 Sq ft	14 × 21.7 =	303.8
		19 × 19.5 =	370.5
		12.5 × 22.4 =	280
		0.1 × 9.5 =	0.95
<b>Total Living Area (Rounded):</b>	<b>2785 Sq ft</b>		
Non-living Area			
2 Car Attached	481.5 Sq ft	21.4 × 22.5 =	481.5