

# INVOICE

**FROM:**

Advanced Appraisal Services  
 Advanced Appraisal Services  
 PO Box 11373  
 Knoxville, TN 37939-1373

Telephone Number: (865) 588-4008      Fax Number: (865) 637-2394

**TO:**

The Holli McCray Group

Knoxville, TN

E-Mail: verdeaux@kw.com

Telephone Number: (865) 851-0181      Fax Number:

Alternate Number:

**INVOICE NUMBER**

0045075

**DATES**

Invoice Date: 07/09/2019

Due Date: 07/09/2019

**REFERENCE**

Internal Order #: 0045075

Lender Case #:

Client File #:

FHA/VA Case #:

Main File # on form: 0045075

Other File # on form: 0045075

Federal Tax ID: 62-1867763

Employer ID:

**DESCRIPTION**

|   |                                       |
|---|---------------------------------------|
| <b>Lender:</b> The Holli McCray Group                 | <b>Client:</b> The Holli McCray Group |
| <b>Purchaser/Borrower:</b> The Holli McCray Group     |                                       |
| <b>Property Address:</b> 1313 Holston Shores          |                                       |
| <b>City:</b> Rutledge                                 |                                       |
| <b>County:</b> Grainger                               | <b>State:</b> TN <b>Zip:</b> 37932    |
| <b>Legal Description:</b> Lot 4 Riverview Subdivision |                                       |

**FEES**

**AMOUNT**

|             |       |
|-------------|-------|
| Measurement | 75.00 |
| Travel Fee  | 25.00 |

**SUBTOTAL**      100.00

**PAYMENTS**

**AMOUNT**

|                 |              |                     |
|-----------------|--------------|---------------------|
| <b>Check #:</b> | <b>Date:</b> | <b>Description:</b> |
| Check #:        | Date:        | Description:        |
| Check #:        | Date:        | Description:        |

**SUBTOTAL**      0

**TOTAL DUE**      \$ 100.00

**Supplemental Addendum**

File No. 0045075

|                  |                        |        |          |       |                   |
|------------------|------------------------|--------|----------|-------|-------------------|
| Borrower         | The Holli McCray Group |        |          |       |                   |
| Property Address | 1313 Holston Shores    |        |          |       |                   |
| City             | Rutledge               | County | Grainger | State | TN Zip Code 37932 |
| Lender/Client    | The Holli McCray Group |        |          |       |                   |

**1313 Holston Shores- 2904 sq ft**

**1st Level- 1781 sq ft**

- Great Room 21 x 19**
- Kitchen 16 x 12**
- Dining 18 x 15**
- Laundry 11 x 12**
- Master Bed 17 x 17**
- Master Bath 14 x 8**
- Half Bath 8 x 4**

**2nd Level- 1123 sq ft**

- Bed 2 12 x 15**
- Bed 3 12 x 15**
- Bath 12 x 12**
- Bonus 20 x 17**

Signature \_\_\_\_\_  
 Name Jeremy Skalet  
 Date Signed \_\_\_\_\_  
 State Certification # 3215 State TN  
 Or State License # \_\_\_\_\_ State \_\_\_\_\_

Signature \_\_\_\_\_  
 Name \_\_\_\_\_  
 Date Signed \_\_\_\_\_  
 State Certification # \_\_\_\_\_ State \_\_\_\_\_  
 Or State License # \_\_\_\_\_ State \_\_\_\_\_

## Subject Photo Page

|                  |                        |        |          |          |       |
|------------------|------------------------|--------|----------|----------|-------|
| Borrower         | The Holli McCray Group |        |          |          |       |
| Property Address | 1313 Holston Shores    |        |          |          |       |
| City             | Rutledge               | County | Grainger | State    | TN    |
| Lender/Client    | The Holli McCray Group |        |          |          |       |
|                  |                        |        |          | Zip Code | 37932 |



### Subject Front

1313 Holston Shores  
 Sales Price  
 Gross Living Area    2,904  
 Total Rooms  
 Total Bedrooms  
 Total Bathrooms  
 Location  
 View  
 Site  
 Quality  
 Age                                2



### Subject Rear

### Subject Street

### Building Sketch

|                  |                        |        |          |       |    |          |       |
|------------------|------------------------|--------|----------|-------|----|----------|-------|
| Borrower         | The Holli McCray Group |        |          |       |    |          |       |
| Property Address | 1313 Holston Shores    |        |          |       |    |          |       |
| City             | Rutledge               | County | Grainger | State | TN | Zip Code | 37932 |
| Lender/Client    | The Holli McCray Group |        |          |       |    |          |       |

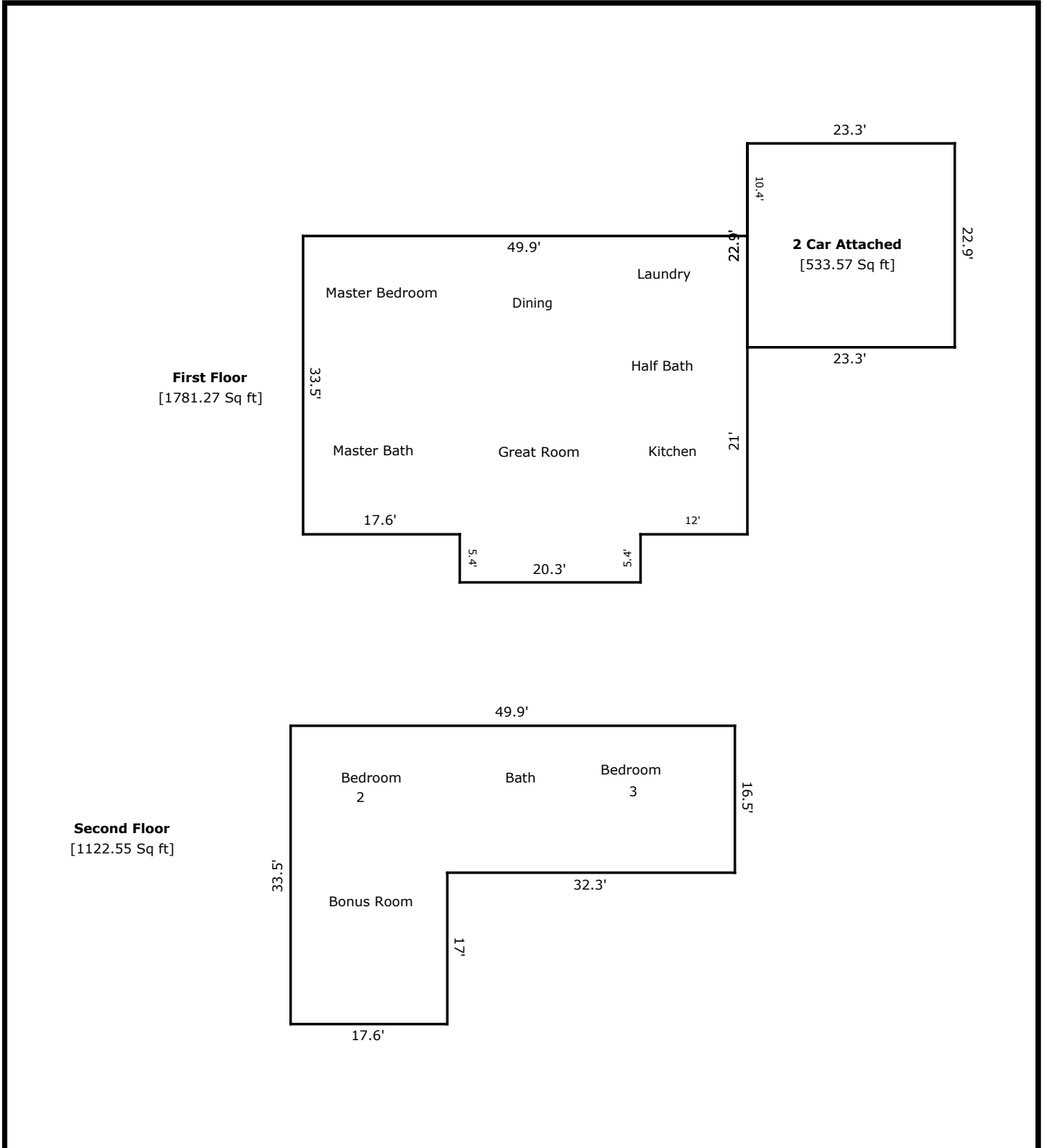

TOTAL Sketch by a la mode, inc.

#### Area Calculations Summary

| Living Area                         |                   | Calculation Details  |
|-------------------------------------|-------------------|--|
| First Floor                         | 1781.27 Sq ft     | $20.3 \times 5.4 = 109.62$<br>$49.9 \times 33.5 = 1671.65$ |
| Second Floor                        | 1122.55 Sq ft     | $17.6 \times 17 = 299.2$<br>$16.5 \times 49.9 = 823.35$    |
| <b>Total Living Area (Rounded):</b> | <b>2904 Sq ft</b> |  |
| <b>Non-living Area</b>              |                   |  |
| 2 Car Attached                      | 533.57 Sq ft      | $23.3 \times 22.9 = 533.57$                                |