

INVOICE

FROM:

Advanced Appraisal Services
 Advanced Appraisal Services
 PO Box 11373
 Knoxville, TN 37939-1373

Telephone Number: (865) 588-4008 Fax Number: (865) 637-2394

TO:

The Holli McCray Group

Knoxville, TN

E-Mail: verdeaux@kw.com

Telephone Number: (865) 851-0181 Fax Number:

Alternate Number:

INVOICE NUMBER

0044408

DATES

Invoice Date: 05/06/2019

Due Date: 05/06/2019

REFERENCE

Internal Order #: 0044408

Lender Case #:

Client File #:

FHA/VA Case #:

Main File # on form: 0044408

Other File # on form: 0044408

Federal Tax ID: 62-1867763

Employer ID:

DESCRIPTION

Lender: The Holli McCray Group **Client:** The Holli McCray Group
Purchaser/Borrower: Laurie Hall
Property Address: 2134 Blue Sage Ln
City: Knoxville
County: Knox **State:** TN **Zip:** 37932
Legal Description: Lot 90 Meadows Of Millertown Unit 4

FEES

AMOUNT

Measure	75.00
interior	0.00

SUBTOTAL 75.00

PAYMENTS

AMOUNT

Check #:	Date:	Description:	
Check #:	Date:	Description:	
Check #:	Date:	Description:	

SUBTOTAL 0

TOTAL DUE \$ 75.00

Supplemental Addendum

File No. 0044408

Borrower	Laurie Hall		
Property Address	2134 Blue Sage Ln		
City	Knoxville	County	Knox
		State	TN
		Zip Code	37932
Lender/Client	The Holli McCray Group		

2134 Blue Sage- 1430 sq ft

- Kitchen 12 x 10**
- Dining 12 x 10**
- Living 16 x 18**
- Bath 2 8 x 5**
- Bed 2 11 x 11**
- Bed 3 11 x 11**
- Laundry 5 x 6**
- Master Bed 12 x 14**
- Master Bath 11 x 5**

Signature _____
Name Jeremy Skalet
Date Signed _____
State Certification # 3215 State TN
Or State License # _____ State _____

Signature _____
Name _____
Date Signed _____
State Certification # _____ State _____
Or State License # _____ State _____

Subject Photo Page

Borrower	Laurie Hall						
Property Address	2134 Blue Sage Ln						
City	Knoxville	County	Knox	State	TN	Zip Code	37932
Lender/Client	The Holli McCray Group						



Subject Front

2134 Blue Sage Ln

1,430

14



Subject Rear

Subject Street

Building Sketch

Borrower	Laurie Hall				
Property Address	2134 Blue Sage Ln				
City	Knoxville	County	Knox	State	TN
Lender/Client	The Holli McCray Group				
				Zip Code	37932

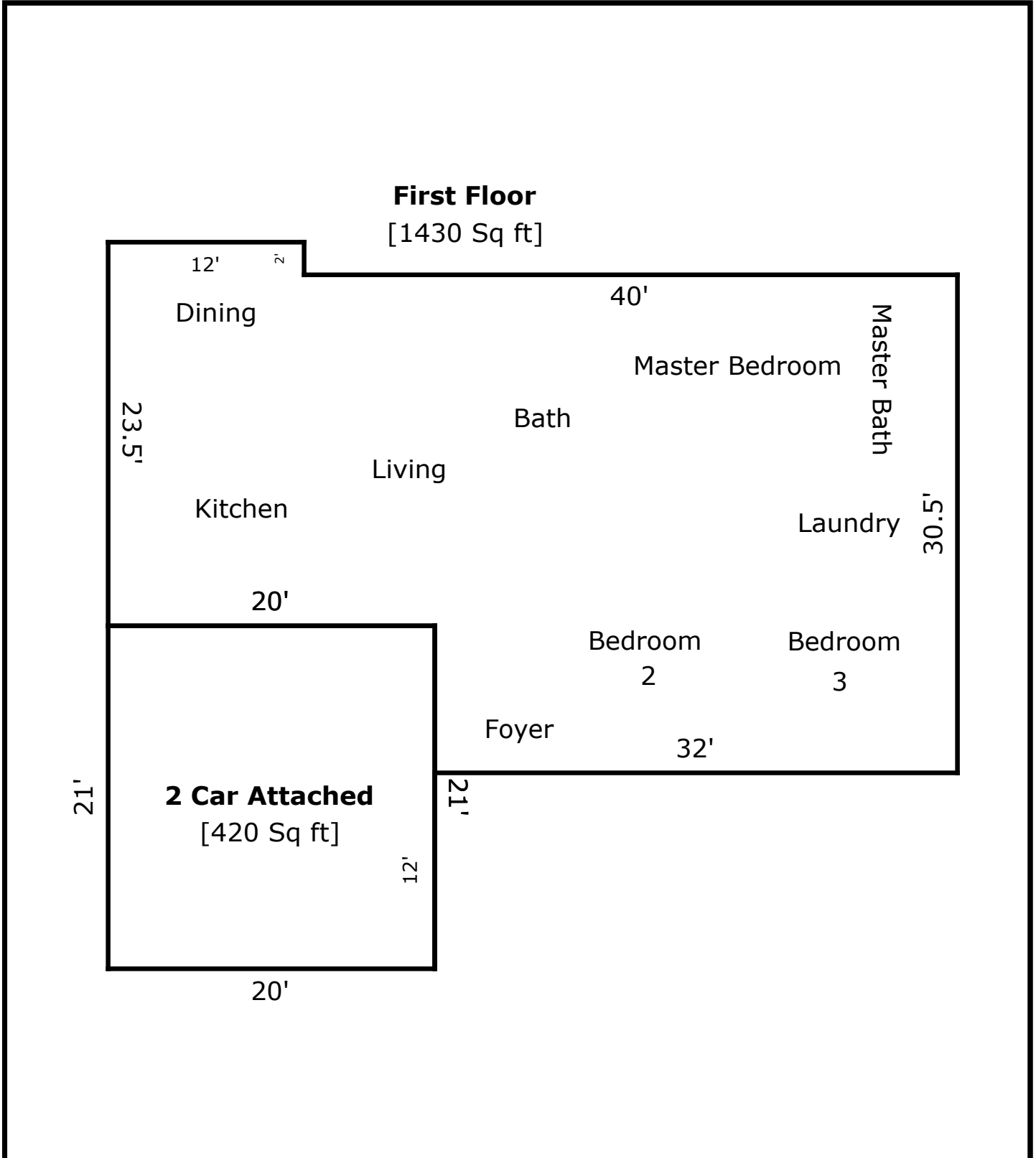

TOTAL Sketch by a la mode, inc.

Area Calculations Summary

Living Area		Calculation Details
First Floor	1430 Sq ft	$30.5 \times 32 = 976$ $20 \times 21.5 = 430$ $2 \times 12 = 24$
Total Living Area (Rounded):	1430 Sq ft	
Non-living Area		
2 Car Attached	420 Sq ft	$21 \times 20 = 420$