

# INVOICE

**FROM:**

Advanced Appraisal Services  
 Advanced Appraisal Services  
 PO Box 11373  
 Knoxville, TN 37939-1373

Telephone Number: (865) 588-4008      Fax Number: (865) 637-2394

**TO:**

The Holli McCray Group

Knoxville, TN

E-Mail: verdeaux@kw.com

Telephone Number: (865) 851-0181      Fax Number:

Alternate Number:

**INVOICE NUMBER**

0044367

**DATES**

Invoice Date: 04/29/2019

Due Date: 04/29/2019

**REFERENCE**

Internal Order #: 0044367

Lender Case #:

Client File #:

FHA/VA Case #:

Main File # on form: 0044367

Other File # on form: 0044367

Federal Tax ID: 62-1867763

Employer ID:

**DESCRIPTION**

<b>Lender:</b> The Holli McCray Group	<b>Client:</b> The Holli McCray Group
<b>Purchaser/Borrower:</b> Wes Hightower	
<b>Property Address:</b> 1505 Nutgrove	
<b>City:</b> Knoxville	
<b>County:</b> Knox	<b>State:</b> TN <b>Zip:</b> 37932
<b>Legal Description:</b> Trails End S/D Unit 6 Lot 15	

**FEES**

**AMOUNT**

Measure interior	75.00 0.00
<b>SUBTOTAL</b>	75.00

**PAYMENTS**

**AMOUNT**

<b>Check #:</b>	<b>Date:</b>	<b>Description:</b>	
<b>Check #:</b>	<b>Date:</b>	<b>Description:</b>	
<b>Check #:</b>	<b>Date:</b>	<b>Description:</b>	
<b>SUBTOTAL</b>			0
<b>TOTAL DUE</b>			<b>\$ 75.00</b>

**Supplemental Addendum**

File No. 0044367

Borrower	Wes Hightower		
Property Address	1505 Nutgrove		
City	Knoxville	County	Knox
		State	TN
		Zip Code	37932
Lender/Client	The Holli McCray Group		

**1505 Nutgrove- 2317 sq ft**

- Laundry/Half Bath 9 x 6**
- Master Bed 19 x 16**
- Master Bath 13 x 9**
- Kitchen 15 x 9**
- Breakfast 12 x 8**
- Living 22 x 14**
- Dining 13 x 12**
- Office 12 x 12**
- Bed 2 13 x 11**
- Bath 10 x 5**
- Bed 3 13 x 12**

Signature \_\_\_\_\_  
 Name Jeremy Skalet  
 Date Signed \_\_\_\_\_  
 State Certification # 3215 State TN  
 Or State License # \_\_\_\_\_ State \_\_\_\_\_

Signature \_\_\_\_\_  
 Name \_\_\_\_\_  
 Date Signed \_\_\_\_\_  
 State Certification # \_\_\_\_\_ State \_\_\_\_\_  
 Or State License # \_\_\_\_\_ State \_\_\_\_\_

**Subject Photo Page**

Borrower	Wes Hightower				
Property Address	1505 Nutgrove				
City	Knoxville	County	Knox	State	TN
Lender/Client	The Holli McCray Group				
				Zip Code	37932



**Subject Front**

1505 Nutgrove

2,317



**Subject Rear**

**Subject Street**

### Building Sketch

Borrower	Wes Hightower				
Property Address	1505 Nutgrove				
City	Knoxville	County	Knox	State	TN
Lender/Client	The Holli McCray Group				
				Zip Code	37932

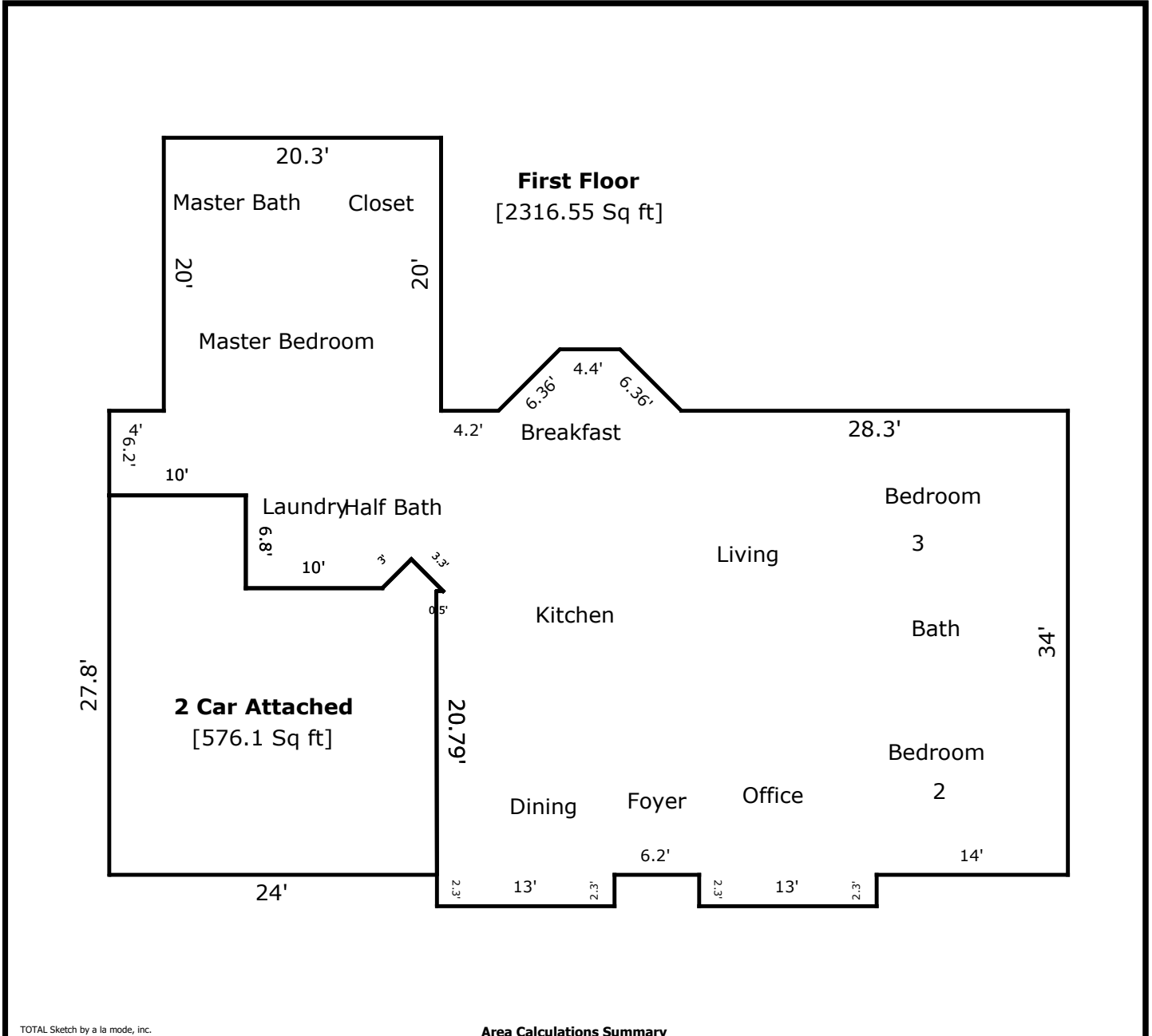

TOTAL Sketch by a la mode, inc.

**Area Calculations Summary**

Living Area		Calculation Details	
First Floor	2316.55 Sq ft	13 × 2.3	= 29.9
		13 × 2.3	= 29.9
		0.5 × 4.5 × 4.5	= 10.12
		0.5 × 4.5 × 4.5	= 10.12
		4.4 × 4.5	= 19.8
		20.3 × 20	= 406
		34 × 45.75	= 1555.34
		20.79 × 0.45	= 9.45
		0.5 × 20.79 × 0.05	= 0.47
		6.2 × 10	= 62
		13 × 10	= 130
		4.45 × 10.88	= 48.46
		0.5 × 2.33 × 2.33	= 2.72
		0.5 × 2.12 × 2.12	= 2.25
<b>Total Living Area (Rounded):</b>	<b>2317 Sq ft</b>		
Non-living Area			
2 Car Attached	576.1 Sq ft	0.5 × 20.79 × 0.05	= 0.47
		23.95 × 20.79	= 497.97
		0.5 × 0.21 × 0.21	= 0.02
		24.24 × 0.21	= 5.14
		0.5 × 4.24 × 2.12	= 4.5
		10 × 6.8	= 68