

Subject Photo Page

Borrower	Nancy Westerling						
Property Address	11406 Goldenview Ln						
City	Knoxville	County	Knox	State	TN	Zip Code	37932
Lender/Client	Nancy Westerling						



Subject Front

Subject Rear

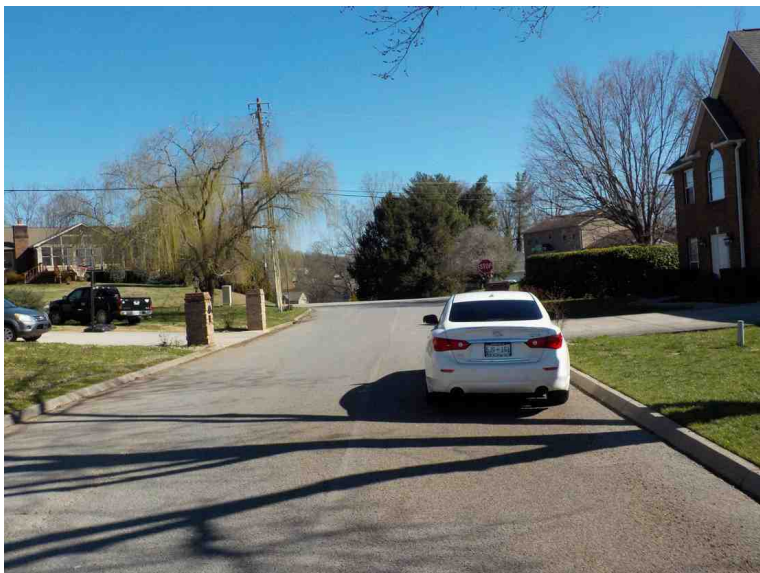

Subject Street

Supplemental Addendum

File No. 0043858

Borrower	Nancy Westerling				
Property Address	11406 Goldenview Ln				
City	Knoxville	County	Knox	State	TN
Lender/Client	Nancy Westerling				
				Zip Code	37932

Measurements for 11406 Goldenview Ln

1st Floor **1112 square feet**

2nd Floor **1128 square feet**

The above measurements are completed according to appraisal industry standards.

Interior Room Measurements**1st Floor**

Kitchen **19 x 12**

Family Room **18 x 14**

Living Room **12 x 11**

Dining Room **12 x 11**

Powder **6 x 4.5**

Laundry **6 x 6**

2nd Floor

Master Bedroom **15.5 x 13**

Master Bathroom **13 x 12.5 x irregular**

Bedroom **10.5 x 10**

Bathroom **10 x 5**

Bedroom **11 x 10.5**

Bedroom **11 x 11**

The room measurements are interior wall to interior wall and rounded to the nearest 0.5 foot.

Building Sketch

Borrower	Nancy Westerling				
Property Address	11406 Goldenview Ln				
City	Knoxville	County	Knox	State	TN
Lender/Client	Nancy Westerling				
				Zip Code	37932

1st Level

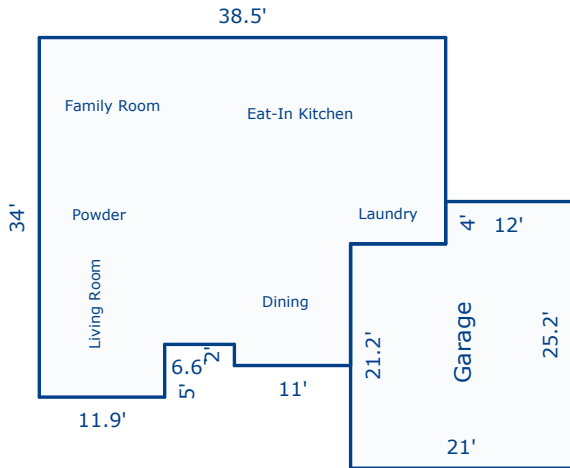

2nd Level

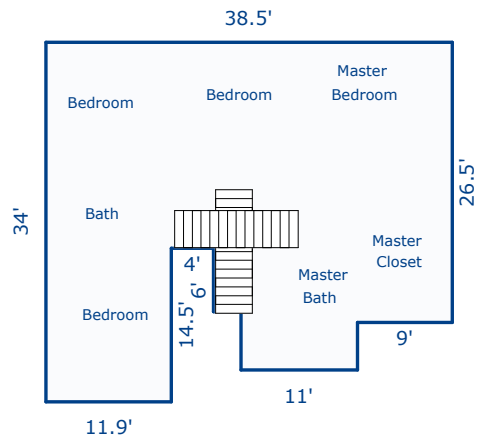

Sketch by Apex Sketch v5 Standard™

Comments:

AREA CALCULATIONS SUMMARY			
Code	Description	Net Size	Net Totals
GLA1	First Floor	1112.50	
	Second Floor	1128.40	2240.90
GAR	Garage	493.20	493.20
Net LIVABLE Area		(rounded)	2241

LIVING AREA BREAKDOWN			
Breakdown			Subtotals
First Floor			
19.5	x	38.5	750.75
9.5	x	29.5	280.25
2.0	x	11.0	22.00
5.0	x	11.9	59.50
Second Floor			
19.5	x	38.5	750.75
14.5	x	11.9	172.55
6.0	x	22.6	135.60
1.0	x	20.0	20.00
4.5	x	11.0	49.50
9 Items	(rounded)		2241