

INVOICE

FROM:

Advanced Appraisal Services
 Advanced Appraisal Services
 PO Box 11373
 Knoxville, TN 37939-1373

Telephone Number: (865) 588-4008 Fax Number: (865) 637-2394

TO:

The Holli McCray Group

Knoxville, TN

E-Mail: verdeaux@kw.com

Telephone Number: (865) 851-0181 Fax Number:

Alternate Number:

INVOICE NUMBER

0042704

DATES

Invoice Date: 09/18/2018

Due Date: 09/18/2018

REFERENCE

Internal Order #: 0042704

Lender Case #:

Client File #:

FHA/VA Case #:

Main File # on form: 0042704

Other File # on form: 0042704

Federal Tax ID: 62-1867763

Employer ID:

DESCRIPTION

Lender: The Holli McCray Group **Client:** The Holli McCray Group
Purchaser/Borrower: Barry Vanover
Property Address: 8712 Shoreham
City: Knoxville
County: Knox **State:** TN **Zip:** 3
Legal Description: Block B Lot 6 Brentmoor Unit 2

FEES

AMOUNT

Measure interior	75.00
	0.00
SUBTOTAL	75.00

PAYMENTS

AMOUNT

Check #:	Date:	Description:	
Check #:	Date:	Description:	
Check #:	Date:	Description:	
SUBTOTAL			0
TOTAL DUE			\$ 75.00

Supplemental Addendum

File No. 0042704

Borrower	Barry Vanover		
Property Address	8712 Shoreham		
City	Knoxville	County	Knox
		State	TN
		Zip Code	3
Lender/Client	The Holli McCray Group		

8712 Shoreham- 1731 sq ft

- Sunroom 16 x 15**
- Master Bed 12 x 15**
- Master Bath 13 x 5**
- Living 17 x 15**
- Kitchen 8 x 13**
- Dining 12 x 9**
- Bed 2 11 x 10**
- Bed 3 11 x 10**
- Bath 8 x 5**

Signature _____
Name Jeremy Skalet
Date Signed _____
State Certification # 3215 State TN
Or State License # _____ State _____

Signature _____
Name _____
Date Signed _____
State Certification # _____ State _____
Or State License # _____ State _____

Subject Photo Page

Borrower	Barry Vanover						
Property Address	8712 Shoreham						
City	Knoxville	County	Knox	State	TN	Zip Code	3
Lender/Client	The Holli McCray Group						



Subject Front

8712 Shoreham

1,731



Subject Rear

Subject Street

Building Sketch

Borrower	Barry Vanover				
Property Address	8712 Shoreham				
City	Knoxville	County	Knox	State	TN
Lender/Client	The Holli McCray Group				
				Zip Code	3

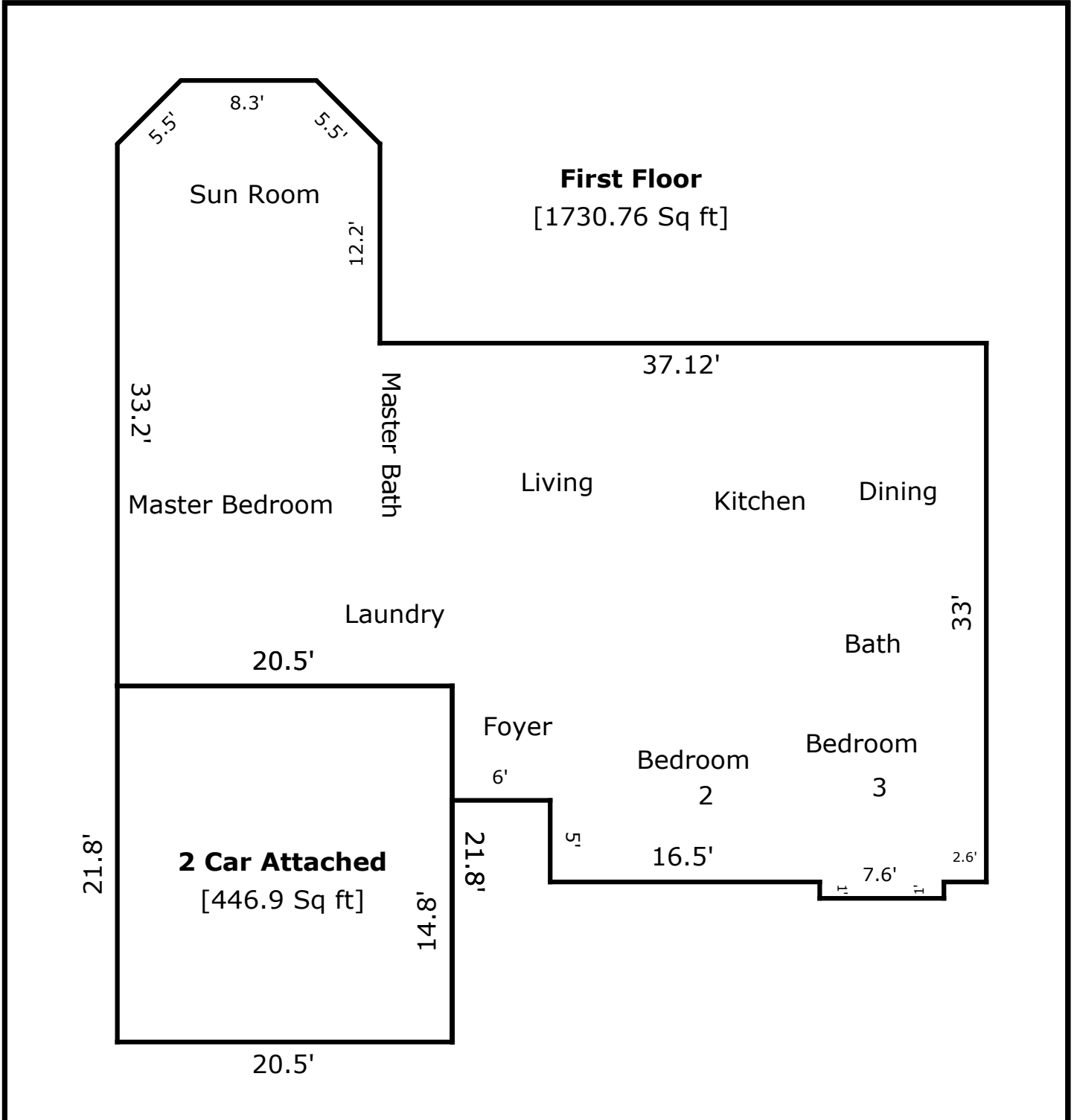

TOTAL Sketch by a la mode, inc.

Area Calculations Summary

Living Area		Calculation Details	
First Floor	1730.76 Sq ft	7.6×1	= 7.6
		26.7×5	= 133.5
		32.7×7	= 228.9
		53.2×21	= 1117.2
		16.08×12.2	= 196.15
		$0.5 \times 3.89 \times 3.89$	= 7.56
		$0.5 \times 3.89 \times 3.89$	= 7.56
		8.3×3.89	= 32.28
Total Living Area (Rounded):	1731 Sq ft		
Non-living Area			
2 Car Attached	446.9 Sq ft	21.8×20.5	= 446.9