

INVOICE

FROM:

Advanced Appraisal Services
 Advanced Appraisal Services
 PO Box 11373
 Knoxville, TN 37939-1373

Telephone Number: (865) 588-4008 Fax Number: (865) 637-2394

TO:

The Holli McCray Group

Knoxville, TN

E-Mail: verdeaux@kw.com

Telephone Number: (865) 851-0181 Fax Number:

Alternate Number:

INVOICE NUMBER

0042690

DATES

Invoice Date: 09/20/2018

Due Date: 09/20/2018

REFERENCE

Internal Order #: 0042690

Lender Case #:

Client File #:

FHA/VA Case #:

Main File # on form: 0042690

Other File # on form: 0042690

Federal Tax ID: 62-1867763

Employer ID:

DESCRIPTION

Lender: The Holli McCray Group Client: The Holli McCray Group
 Purchaser/Borrower: Peter Salzman
 Property Address: 724 Exodus
 City: Knoxville
 County: Knox State: TN Zip: 37932
 Legal Description: Lot 4 Stonebridge Gardens Unit 2

FEES

AMOUNT

Measure	75.00
interior	0.00

SUBTOTAL 75.00

PAYMENTS

AMOUNT

Check #:	Date:	Description:
Check #:	Date:	Description:
Check #:	Date:	Description:

SUBTOTAL 0

TOTAL DUE \$ 75.00

Supplemental Addendum

File No. 0042690

Borrower	Peter Salzman				
Property Address	724 Exodus				
City	Knoxville	County	Knox	State	TN
Lender/Client	The Holli McCray Group				
	Zip Code	37932			

724 Exodus- 1302 sq ft

- Living 14 x 17**
- Kitchen 10 x 17**
- Laundry 6 x 6**
- Bed 2 14 x 10**
- Bath 8 x 5**
- Master Bed 14 x 12**
- Master Bath 8 x 5**
- Sun Room 21 x 9**

Signature _____
Name Jeremy Skalet
Date Signed _____
State Certification # 3215 State TN
Or State License # _____ State _____

Signature _____
Name _____
Date Signed _____
State Certification # _____ State _____
Or State License # _____ State _____

Subject Photo Page

Borrower	Peter Salzman						
Property Address	724 Exodus						
City	Knoxville	County	Knox	State	TN	Zip Code	37932
Lender/Client	The Holli McCray Group						



Subject Front

724 Exodus

1,302



Subject Rear

Subject Street

Building Sketch

Borrower	Peter Salzman			
Property Address	724 Exodus			
City	Knoxville	County	Knox	State TN Zip Code 37932
Lender/Client	The Holli McCray Group			

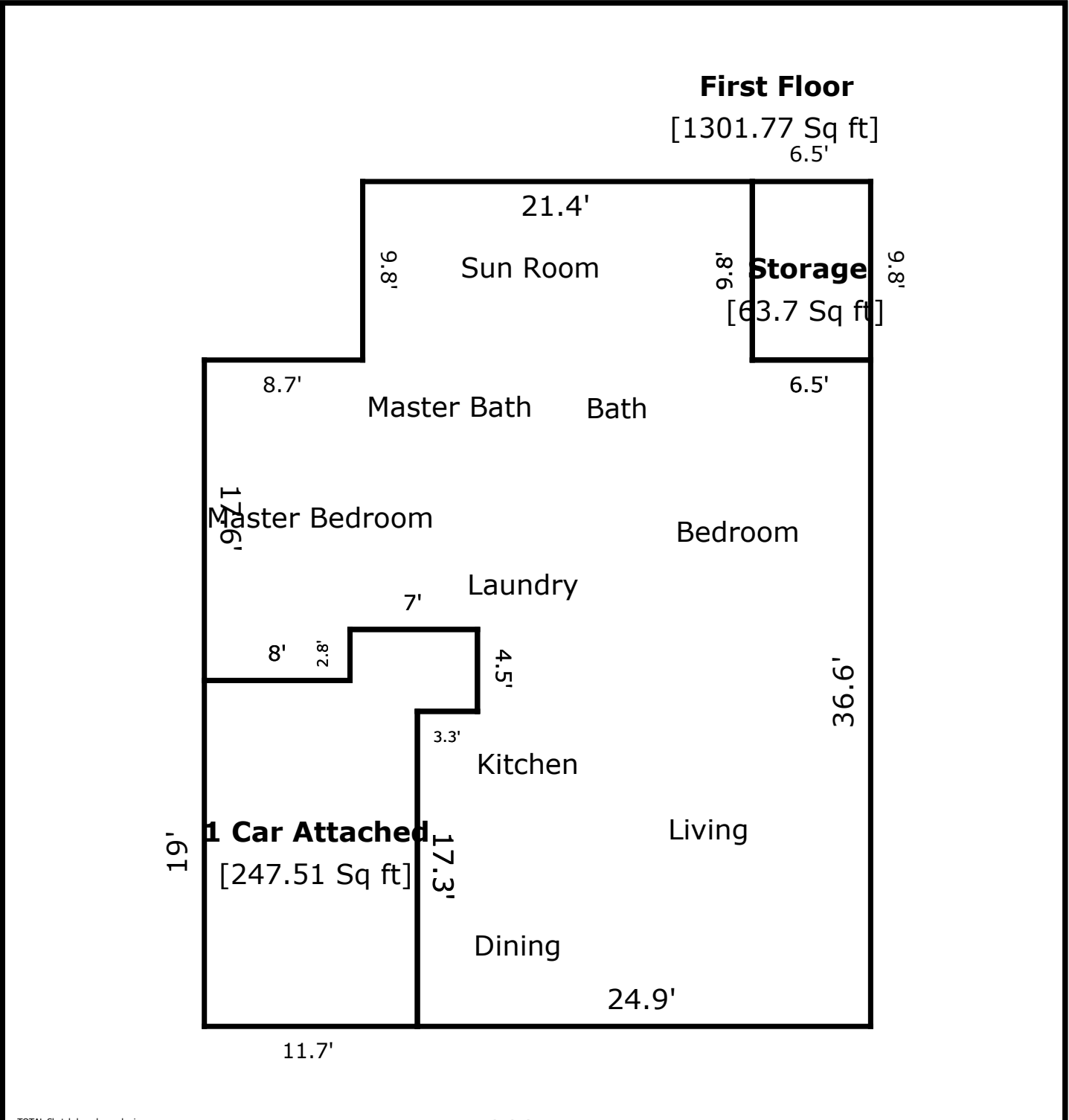

TOTAL Sketch by a la mode, inc.

Area Calculations Summary

Living Area		Calculation Details
First Floor	1301.77 Sq ft	$21.4 \times 9.8 = 209.72$ $24.9 \times 17.3 = 430.77$ $19.3 \times 21.6 = 416.88$ $15 \times 14.8 = 222$ $2.8 \times 8 = 22.4$
Total Living Area (Rounded):	1302 Sq ft	
Non-living Area		
Storage	63.7 Sq ft	$9.8 \times 6.5 = 63.7$
1 Car Attached	247.51 Sq ft	$4.5 \times 3.3 = 14.85$ $3.7 \times 2.8 = 10.36$ $19 \times 11.7 = 222.3$