

# INVOICE

**FROM:**

Advanced Appraisal Services  
 Advanced Appraisal Services  
 PO Box 11373  
 Knoxville, TN 37939-1373

Telephone Number: (865) 588-4008      Fax Number: (865) 637-2394

**TO:**

The Holli McCray Group

Knoxville, TN

E-Mail: verdeaux@kw.com

Telephone Number: (865) 851-0181      Fax Number:

Alternate Number:

**INVOICE NUMBER**

0042705

**DATES**

Invoice Date: 09/20/2018

Due Date: 09/20/2018

**REFERENCE**

Internal Order #: 0042705

Lender Case #:

Client File #:

FHA/VA Case #:

Main File # on form: 0042705

Other File # on form:

Federal Tax ID: 62-1867763

Employer ID:

**DESCRIPTION**

<b>Lender:</b> The Holli McCray Group	<b>Client:</b> The Holli McCray Group
<b>Purchaser/Borrower:</b> The Holli McCray Group	
<b>Property Address:</b> 5086 Dovewood	
<b>City:</b> Knoxville	
<b>County:</b> Knox	<b>State:</b> TN <b>Zip:</b> 37932
<b>Legal Description:</b> Joshuas Landing Condos Ph-1 Unit 7	

**FEES**

**AMOUNT**

Measure interior	75.00
	0.00
<b>SUBTOTAL</b>	
	75.00

**PAYMENTS**

**AMOUNT**

<b>Check #:</b>	<b>Date:</b>	<b>Description:</b>	
Check #:	Date:	Description:	
Check #:	Date:	Description:	
<b>SUBTOTAL</b>			0
<b>TOTAL DUE</b>			<b>\$ 75.00</b>

# Supplemental Addendum

File No. 0042705

Borrower	The Holli McCray Group		
Property Address	5086 Dovewood		
City	Knoxville	County	Knox
		State	TN
		Zip Code	37932
Lender/Client	The Holli McCray Group		

**5086 Dovewood- 2440 sq ft**

**1st Level- 1993 sq ft**

**Bed 2 12 x 12**

**Bath 8 x 5**

**Bed 3 12 x 12**

**Laundry 13 x 9**

**Dining 12 x 10**

**Living 17 x 15**

**Breakfast 10 x 7**

**Kitchen 10 x 11**

**Master Bed 17 x 13**

**Master Bath 10 x 9**

**2nd Level- 447**

**Bed 19 x 15**

**Bath 9 x 5**

Signature \_\_\_\_\_  
Name Jeremy Skalet  
Date Signed \_\_\_\_\_  
State Certification # 3215 State TN  
Or State License # \_\_\_\_\_ State \_\_\_\_\_

Signature \_\_\_\_\_  
Name \_\_\_\_\_  
Date Signed \_\_\_\_\_  
State Certification # \_\_\_\_\_ State \_\_\_\_\_  
Or State License # \_\_\_\_\_ State \_\_\_\_\_

## Subject Photo Page

Borrower	The Holli McCray Group						
Property Address	5086 Dovewood						
City	Knoxville	County	Knox	State	TN	Zip Code	37932
Lender/Client	The Holli McCray Group						



### Subject Front

5086 Dovewood

2,440



### Subject Rear

### Subject Street

## Building Sketch

Borrower	The Holli McCray Group			
Property Address	5086 Dovewood			
City	Knoxville	County	Knox	State TN      Zip Code 37932
Lender/Client	The Holli McCray Group			

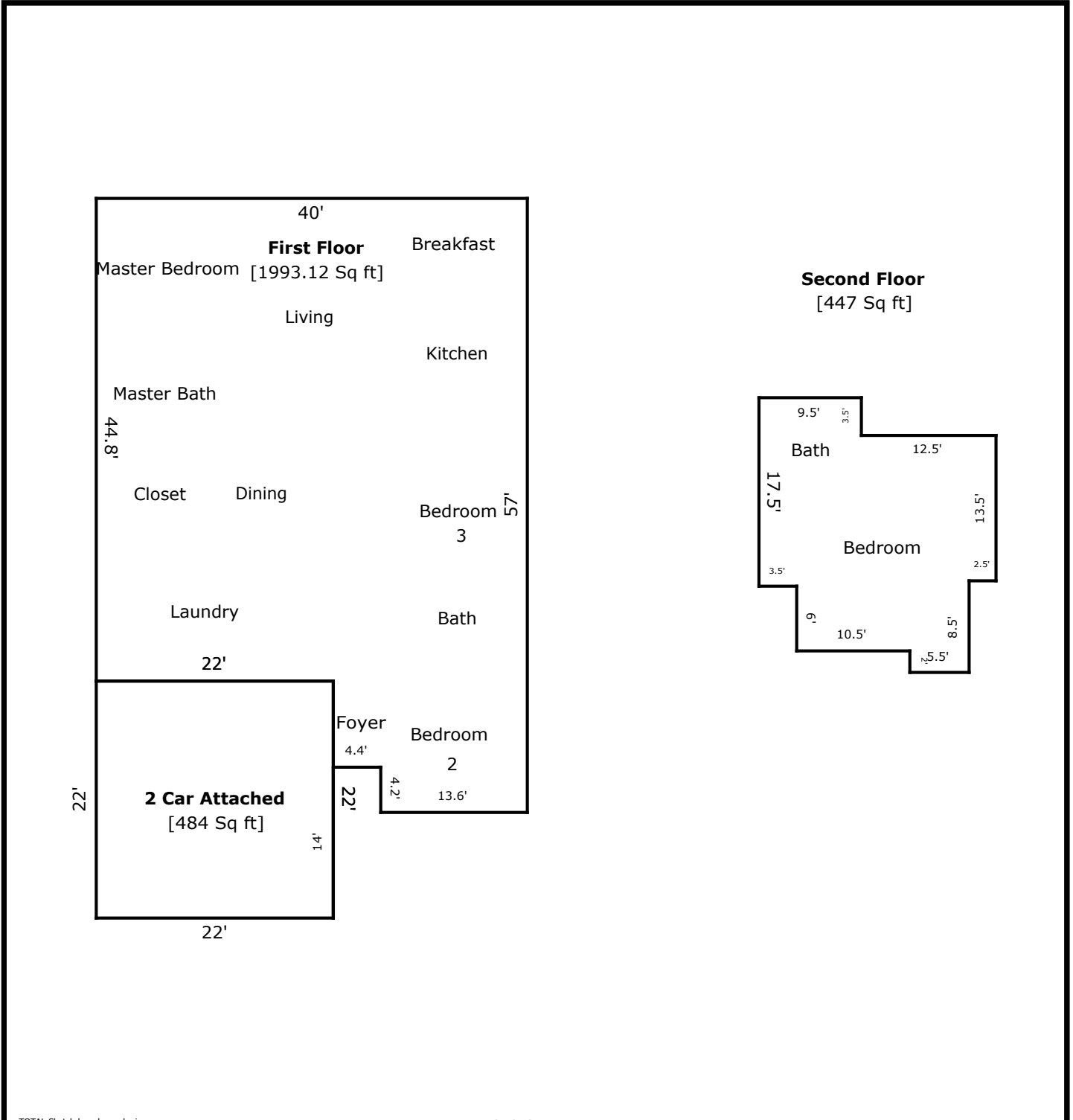

TOTAL Sketch by a la mode, inc.

### Area Calculations Summary

Living Area	Area	Calculation Details
First Floor	1993.12 Sq ft	$57 \times 13.6 = 775.2$ $52.8 \times 4.4 = 232.32$ $22 \times 44.8 = 985.6$
Second Floor	447 Sq ft	$9.5 \times 3.5 = 33.25$ $22 \times 13.5 = 297$ $8.5 \times 5.5 = 46.75$ $6.5 \times 10.5 = 68.25$ $3.5 \times 0.5 = 1.75$
<b>Total Living Area (Rounded):</b>	<b>2440 Sq ft</b>	
<b>Non-living Area</b>		
2 Car Attached	484 Sq ft	$22 \times 22 = 484$