

# INVOICE

**FROM:**

Advanced Appraisal Services  
 Advanced Appraisal Services  
 PO Box 11373  
 Knoxville, TN 37939-1373

Telephone Number: (865) 588-4008      Fax Number: (865) 637-2394

**TO:**

The Holli McCray Group

Knoxville, TN

E-Mail: verdeaux@kw.com

Telephone Number: (865) 851-0181      Fax Number:

Alternate Number:

**INVOICE NUMBER**

0042765

**DATES**

Invoice Date: 09/24/2018

Due Date: 09/24/2018

**REFERENCE**

Internal Order #: 0042765

Lender Case #:

Client File #:

FHA/VA Case #:

Main File # on form: 0042765

Other File # on form: 0042765

Federal Tax ID: 62-1867763

Employer ID:

**DESCRIPTION**

<b>Lender:</b> The Holli McCray Group	<b>Client:</b> The Holli McCray Group
<b>Purchaser/Borrower:</b> The Holli McCray Group	
<b>Property Address:</b> 212 Saligugi Cir	
<b>City:</b> Knoxville	
<b>County:</b> Blount	<b>State:</b> TN <b>Zip:</b> 37932
<b>Legal Description:</b> Book 2291 Page 1254	

**FEES**

**AMOUNT**

Measurement	75.00
interior	0.00

**SUBTOTAL**      75.00

**PAYMENTS**

**AMOUNT**

<b>Check #:</b>	<b>Date:</b>	<b>Description:</b>
Check #:	Date:	Description:
Check #:	Date:	Description:

**SUBTOTAL**      0

**TOTAL DUE**      \$      75.00

# Supplemental Addendum

File No. 0042765

Borrower	The Holli McCray Group						
Property Address	212 Saligugi Cir						
City	Knoxville	County	Blount	State	TN	Zip Code	37932
Lender/Client	The Holli McCray Group						

## 212 Saligugi- 1799 sq ft

- Living 15 x 19
- Dining 10 x 9
- Sun Room 14 x 9
- Kitchen 10 x 9
- Laundry 5 x 9
- Office 11 x 9
- Study 6 x 9
- Bed 2 12 x 11
- Bath 8 x 7
- Bed 2 12 x 11
- Master Bed 16 x 12
- Master Bath 8 x 9

Signature \_\_\_\_\_  
Name Jeremy Skalet  
Date Signed \_\_\_\_\_  
State Certification # 3215 State TN  
Or State License # \_\_\_\_\_ State \_\_\_\_\_

Signature \_\_\_\_\_  
Name \_\_\_\_\_  
Date Signed \_\_\_\_\_  
State Certification # \_\_\_\_\_ State \_\_\_\_\_  
Or State License # \_\_\_\_\_ State \_\_\_\_\_

## Subject Photo Page

Borrower	The Holli McCray Group						
Property Address	212 Saligugi Cir						
City	Knoxville	County	Blount	State	TN	Zip Code	37932
Lender/Client	The Holli McCray Group						



### Subject Front

212 Saligugi Cir

1,799



### Subject Rear

### Subject Street

## Building Sketch

Borrower	The Holli McCray Group			
Property Address	212 Saligugi Cir			
City	Knoxville	County	Blount	State TN      Zip Code 37932
Lender/Client	The Holli McCray Group			

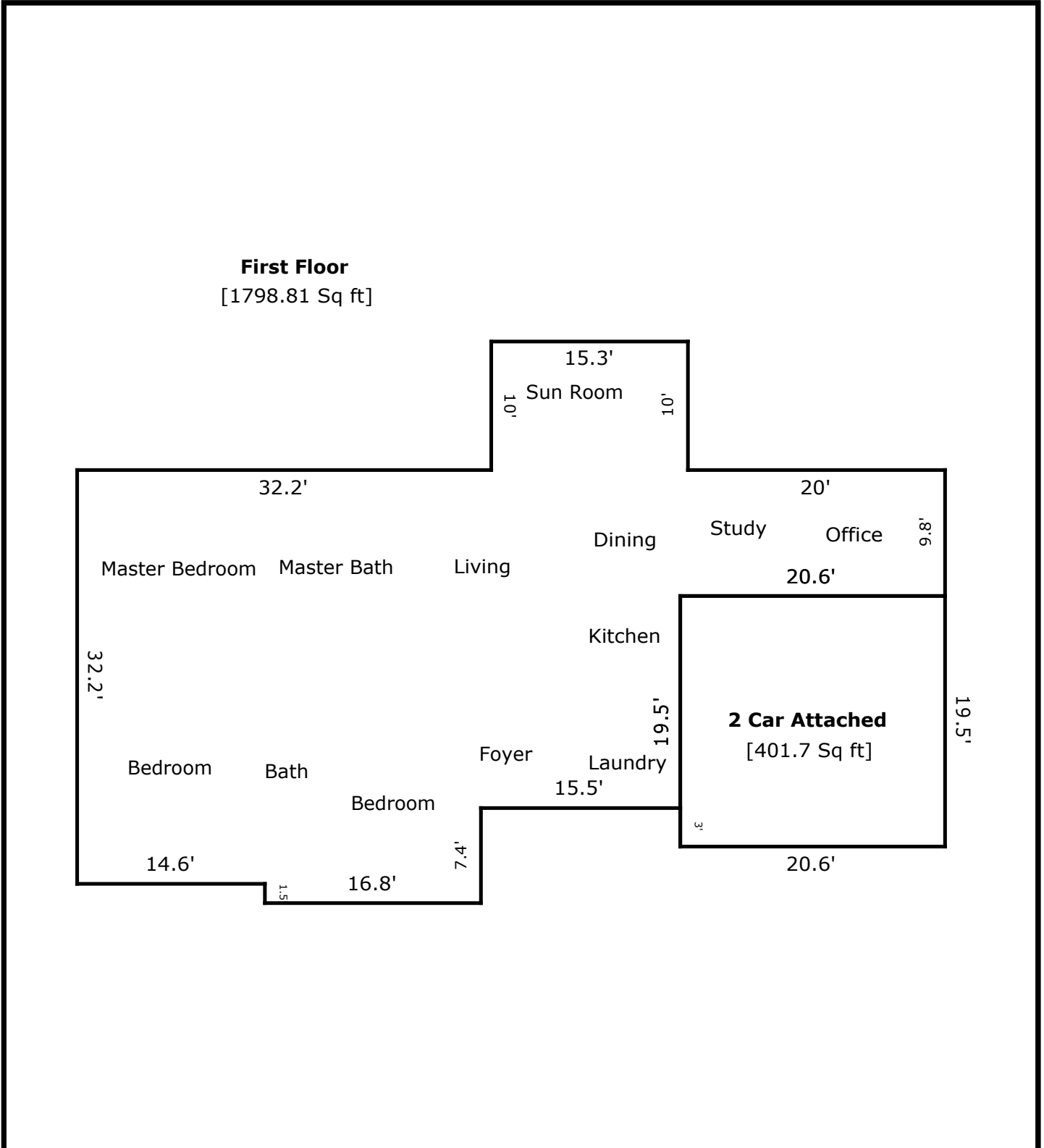

TOTAL Sketch by a la mode, inc.

### Area Calculations Summary

Living Area	Calculation Details	
First Floor	1798.81 Sq ft	$15.3 \times 10 = 153$ $9.8 \times 20.6 = 201.88$ $26.3 \times 15.5 = 407.65$ $31.4 \times 32.2 = 1011.08$ $16.8 \times 1.5 = 25.2$
<b>Total Living Area (Rounded):</b>	<b>1799 Sq ft</b>	
Non-living Area		
2 Car Attached	401.7 Sq ft	$20.6 \times 19.5 = 401.7$