

Supplemental Addendum

File No. 0042837

Borrower	Kadana Coward		
Property Address	1106 Long Meadow		
City	Seymour	County	Knox
		State	TN
		Zip Code	37932
Lender/Client	The Holli McCray Group		

1106 Long Meadow- 1503 sq ft

- Living 17 x 15**
- Master Bed 12 x 14**
- Master Bath 13 x 9**
- Kitchen 13 x 10**
- Dining 12 x 8**
- Bed 2 11 x 12**
- Bed 3 11 x 12**
- Bath 8 x 5**

Signature _____
Name Jeremy Skalet
Date Signed _____
State Certification # 3215 State TN
Or State License # _____ State _____

Signature _____
Name _____
Date Signed _____
State Certification # _____ State _____
Or State License # _____ State _____

Subject Photo Page

Borrower	Kadana Coward				
Property Address	1106 Long Meadow				
City	Seymour	County	Knox	State	TN
Lender/Client	The Holli McCray Group				
				Zip Code	37932



Subject Front

1106 Long Meadow
 Sales Price
 Gross Living Area 1,503
 Total Rooms
 Total Bedrooms
 Total Bathrooms
 Location
 View
 Site
 Quality
 Age

Subject Rear

Subject Street

Building Sketch

Borrower	Kadana Coward				
Property Address	1106 Long Meadow				
City	Seymour	County	Knox	State	TN
Lender/Client	The Holli McCray Group				
				Zip Code	37932

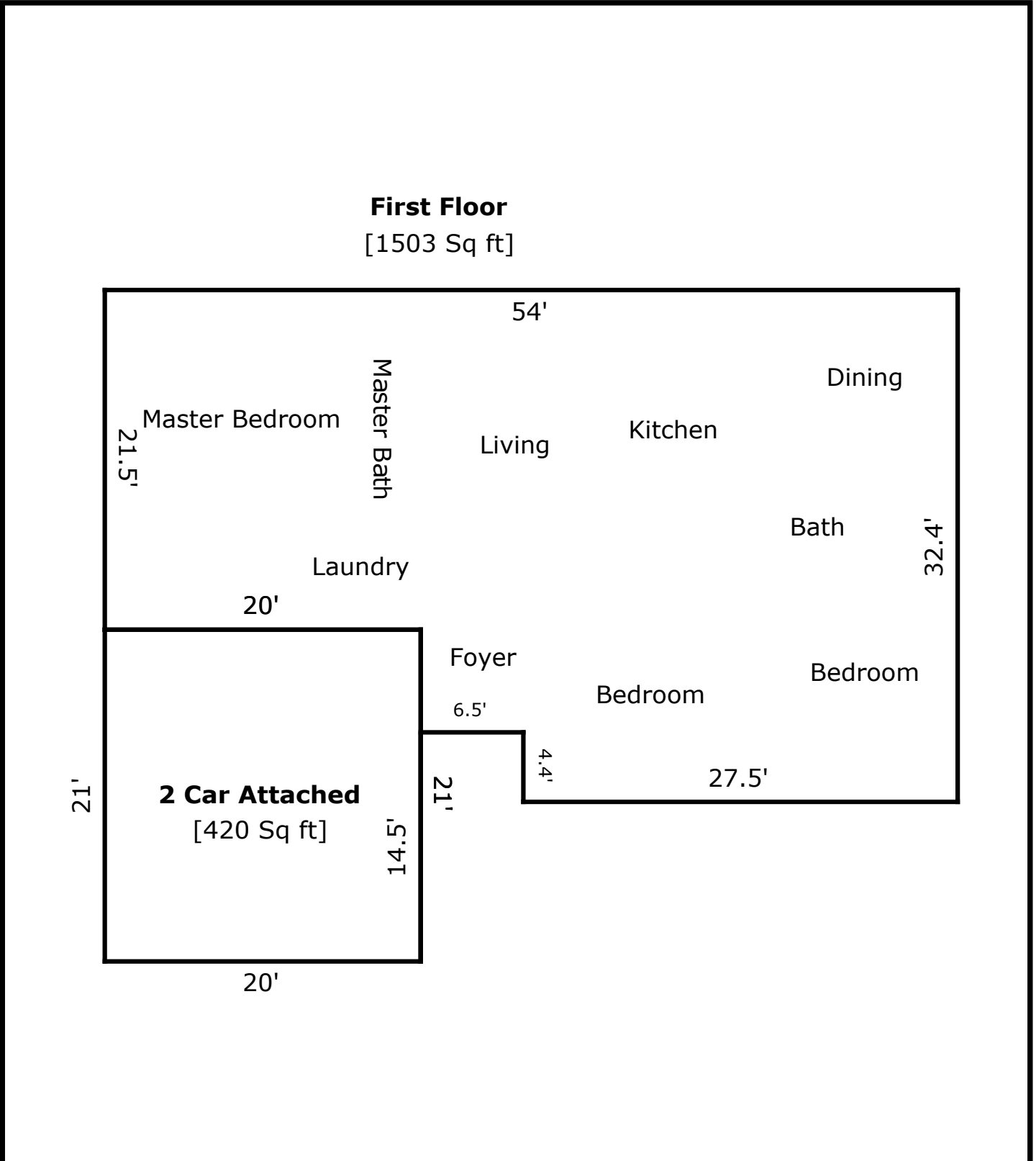

TOTAL Sketch by a la mode, inc.

Area Calculations Summary

Living Area		Calculation Details
First Floor	1503 Sq ft	21.5 × 20 = 430 32.4 × 27.5 = 891 28 × 6.5 = 182
Total Living Area (Rounded):	1503 Sq ft	
Non-living Area		
2 Car Attached	420 Sq ft	21 × 20 = 420