

INVOICE

FROM:

Advanced Appraisal Services
 Advanced Appraisal Services
 PO Box 11373
 Knoxville, TN 37939-1373

Telephone Number: (865) 588-4008 Fax Number: (865) 637-2394

TO:

The Holli McCray Group

Knoxville, TN

E-Mail: verdeaux@kw.com

Telephone Number: (865) 851-0181 Fax Number:

Alternate Number:

INVOICE NUMBER

0042368

DATES

Invoice Date: 08/08/2018

Due Date: 08/08/2018

REFERENCE

Internal Order #: 0042368

Lender Case #:

Client File #:

FHA/VA Case #:

Main File # on form: 0042368

Other File # on form:

Federal Tax ID: 62-1867763

Employer ID:

DESCRIPTION

Lender: The Holli McCray Group	Client: The Holli McCray Group
Purchaser/Borrower: The Holli McCray Group	
Property Address: 5724 Wooded Acres	
City: Knoxville	
County: Knox	State: TN Zip: 37932
Legal Description: Block C Lot 7 Wooded Acres	

FEES

AMOUNT

Measure interior	75.00 0.00
SUBTOTAL	75.00

PAYMENTS

AMOUNT

Check #:	Date:	Description:	
Check #:	Date:	Description:	
Check #:	Date:	Description:	
SUBTOTAL			0

TOTAL DUE \$ 75.00

Supplemental Addendum

File No. 0042368

Borrower	The Holli McCray Group						
Property Address	5724 Wooded Acres						
City	Knoxville	County	Knox	State	TN	Zip Code	37932
Lender/Client	The Holli McCray Group						

5724 Wooded Acres- 1863 sq ft

1st Level- 1290 sq ft

- Living 14 x 14**
- Dining 11 x 9**
- Kitchen 10 x 11**
- Bath 10 x 5**
- Bed 2 10 x 9**
- Bed 3 12 x 9**
- Master Bed 20 x 12**
- Half Bath 8 x 3**

Basement- 572 sq ft

- Laundry/Bath 11 x 7**
- Family 23 x 13**

Signature _____
Name Jeremy Skalet
Date Signed _____
State Certification # 3215 State TN
Or State License # _____ State _____

Signature _____
Name _____
Date Signed _____
State Certification # _____ State _____
Or State License # _____ State _____

Subject Photo Page

Borrower	The Holli McCray Group						
Property Address	5724 Wooded Acres						
City	Knoxville	County	Knox	State	TN	Zip Code	37932
Lender/Client	The Holli McCray Group						



Subject Front

5724 Wooded Acres

1,863



Subject Rear

Subject Street

Building Sketch

Borrower	The Holli McCray Group						
Property Address	5724 Wooded Acres						
City	Knoxville	County	Knox	State	TN	Zip Code	37932
Lender/Client	The Holli McCray Group						

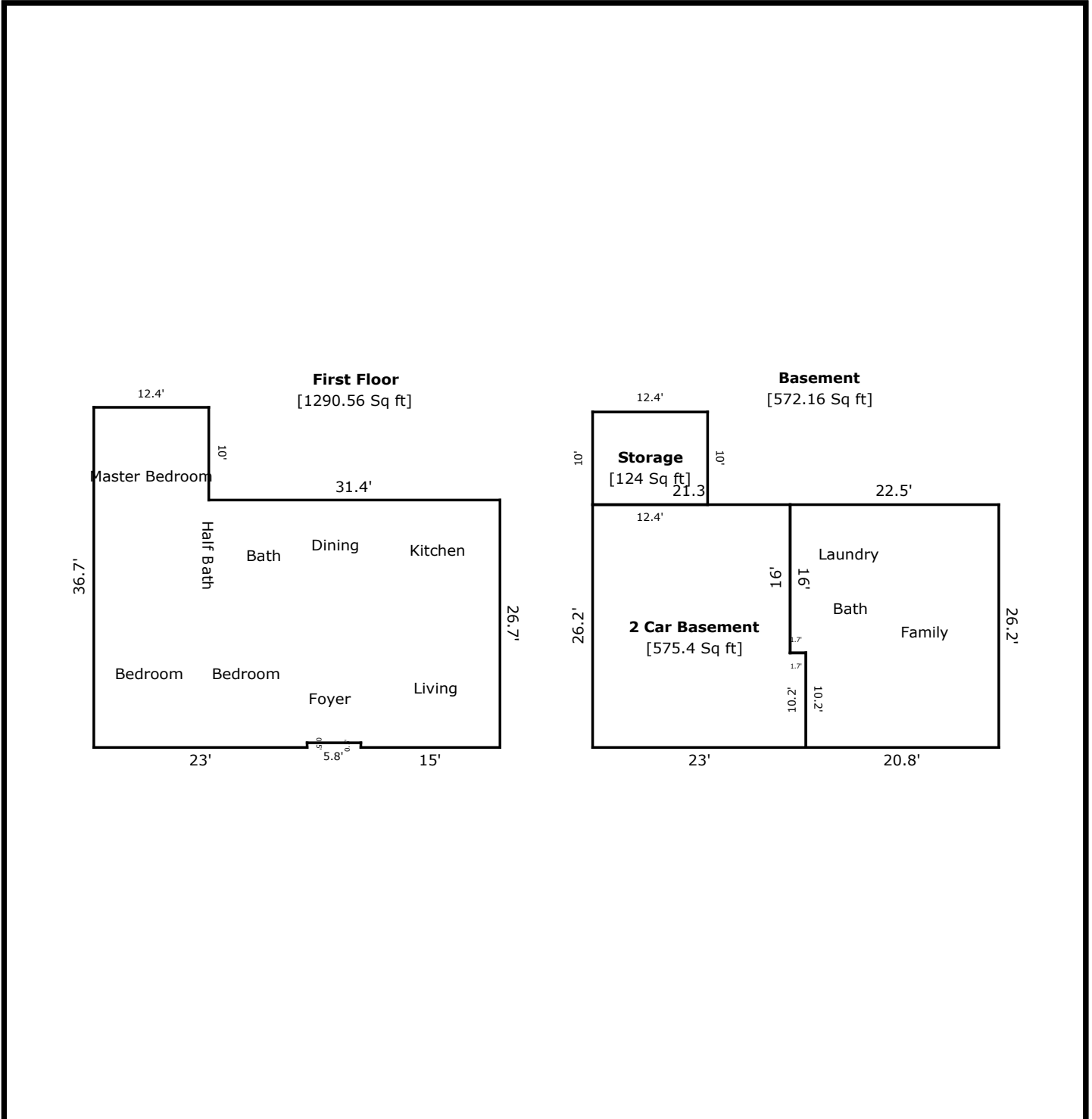

TOTAL Sketch by a la mode, inc.

Area Calculations Summary

Living Area	Calculation Details	
First Floor	1290.56 Sq ft	$12.4 \times 10 = 124$ $26.7 \times 23 = 614.1$ $20.8 \times 26.2 = 544.96$ $0.5 \times 15 = 7.5$
Basement	572.16 Sq ft	$26.2 \times 20.8 = 544.96$ $16 \times 1.7 = 27.2$
Total Living Area (Rounded):	1863 Sq ft	
Non-living Area		
Storage	124 Sq ft	$12.4 \times 10 = 124$
2 Car Basement	575.4 Sq ft	$26.2 \times 21.3 = 558.06$ $1.7 \times 10.2 = 17.34$