

INVOICE

FROM:

Advanced Appraisal Services
 Advanced Appraisal Services
 PO Box 11373
 Knoxville, TN 37939-1373

Telephone Number: (865) 588-4008 Fax Number: (865) 637-2394

TO:

The Holli McCray Group

Knoxville, TN

E-Mail: verdeaux@kw.com

Telephone Number: (865) 851-0181 Fax Number:

Alternate Number:

INVOICE NUMBER

0042345

DATES

Invoice Date: 08/01/2018

Due Date: 08/01/2018

REFERENCE

Internal Order #: 0042345

Lender Case #:

Client File #:

FHA/VA Case #:

Main File # on form: 0042345

Other File # on form:

Federal Tax ID: 62-1867763

Employer ID:

DESCRIPTION

Lender: The Holli McCray Group (order measurements) **Client:** The Holli McCray Group
Purchaser/Borrower: The Holli McCray Group
Property Address: 129 Butterfly
City: Heiskell
County: Anderson **State:** TN **Zip:** 37932
Legal Description: Lot 3 Fairview Trail Sub

FEES

AMOUNT

Measure	75.00
interior	0.00

SUBTOTAL 75.00

PAYMENTS

AMOUNT

Check #:	Date:	Description:
Check #:	Date:	Description:
Check #:	Date:	Description:

SUBTOTAL 0

TOTAL DUE \$ 75.00

Supplemental Addendum

File No. 0042345

Borrower	The Holli McCray Group						
Property Address	129 Butterfly						
City	Heiskell	County	Anderson	State	TN	Zip Code	37932
Lender/Client	The Holli McCray Group (order measurements)						

129 Butterfly- 1480 sq ft

- Office 10 x 7**
- Bed 2 12 x 10**
- Bed 3 12 x 10**
- Bath/Laundry 9 x 9**
- Living 18 x 15**
- Kitchen/Dining 23 x 10**
- Master Bed 13 x 13**
- Master Bath 9 x 8**

Signature _____
Name Jeremy Skalet
Date Signed _____
State Certification # 3215 State TN
Or State License # _____ State _____

Signature _____
Name _____
Date Signed _____
State Certification # _____ State _____
Or State License # _____ State _____

Subject Photo Page

Borrower	The Holli McCray Group						
Property Address	129 Butterfly						
City	Heiskell	County	Anderson	State	TN	Zip Code	37932
Lender/Client	The Holli McCray Group (order measurements)						



Subject Front

129 Butterfly

1,480



Subject Rear

Subject Street

Building Sketch

Borrower	The Holli McCray Group				
Property Address	129 Butterfly				
City	Heiskell	County	Anderson	State	TN
				Zip Code	37932
Lender/Client	The Holli McCray Group (order measurements)				

First Floor
[1480.3 Sq ft]

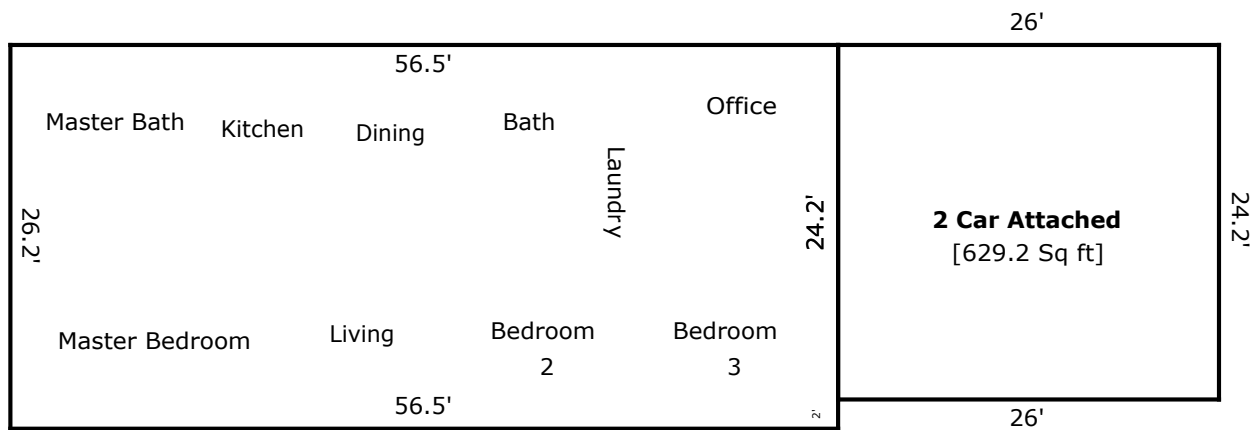

TOTAL Sketch by a la mode, inc.

Area Calculations Summary

Living Area	Calculation Details	
First Floor	1480.3 Sq ft	$56.5 \times 26.2 = 1480.3$
Total Living Area (Rounded):	1480 Sq ft	
Non-living Area	Calculation Details	
2 Car Attached	629.2 Sq ft	$26 \times 24.2 = 629.2$